



2025. M81A

2025L562A1EL

Coimisiún na Scrúduithe Stáit
State Examinations Commission

Leaving Certificate Examination, 2025

Design & Communication Graphics
Higher Level

Section A (60 marks)

Thursday, 19 June
Morning, 9:30 - 12:30

Centre No.

This examination has three sections:

Section A	Core - Short Questions
Section B	Core - Long Questions
Section C	Applied Graphics - Long Questions

Section A

- Four questions are presented.
- Answer **any three** questions on the A3 sheet overleaf.
- All questions in Section A carry **20 marks** each.

General Instructions:

- Construction lines must be shown on all solutions.
- Write the question number distinctly on the answer paper in Sections B and C.
- Work on one side of the drawing paper only.
- All dimensions are given in metres or millimetres.
- Write your Examination number in the box below and on all other sheets used.

Examination Number

Section A - Core - Answer any three of the questions on this A3 sheet.

A-1. The image on the right shows the packaging for a paint product. The drawing shows an incomplete dimetric projection of a similar packaging including a wraparound label, using the axonometric axes method.

- (a) Complete the dimetric projection of the packaging.
- (b) Draw the wraparound label in the axonometric view.

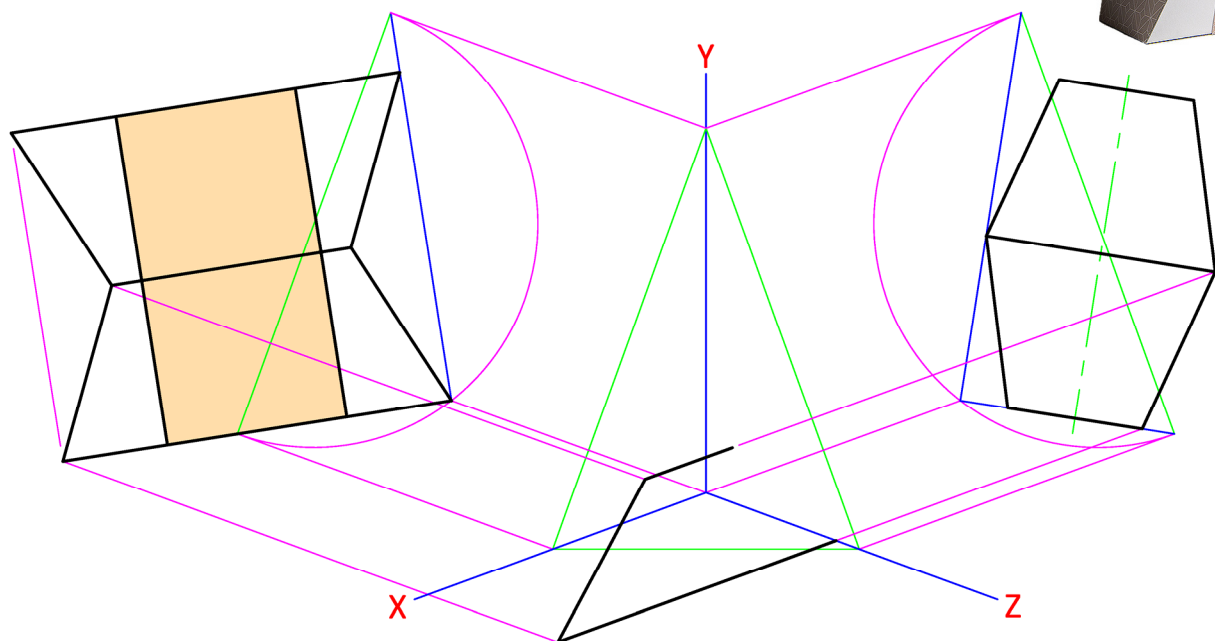

A-3. The image below shows Lionel Messi receiving an award.

The drawing on the right shows the plan and incomplete elevation of a similar award. The top surface of the award is contained on the oblique plane **VTH**.

- (a) Complete the elevation of the award, including all hidden detail.
- (b) Determine the true angle between the **VT** and **HT**.

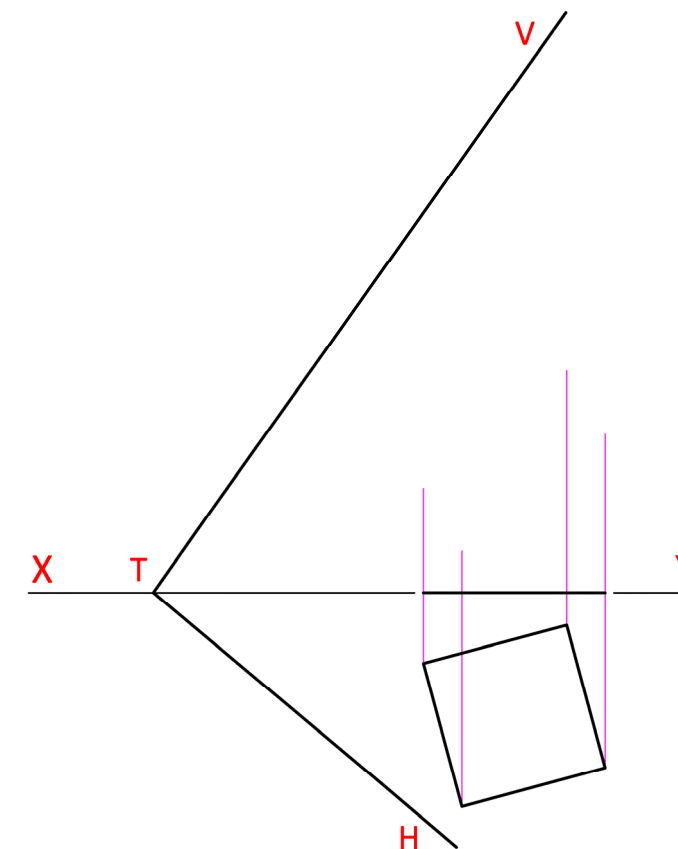

A-2. The image below shows the Futuro office pod in Dublin. The outline of the pod is in the shape of an ellipse.

The drawing below shows the axis **AA₁**, directrix **DD₁**, eccentricity line **E**, vertex **V**, focus **F**, and two points **P** and **Q** on the curve of a similar ellipse.

- (a) Draw the elliptical outline of the pod.
- (b) Determine and indicate the position of the second focal point of the ellipse.

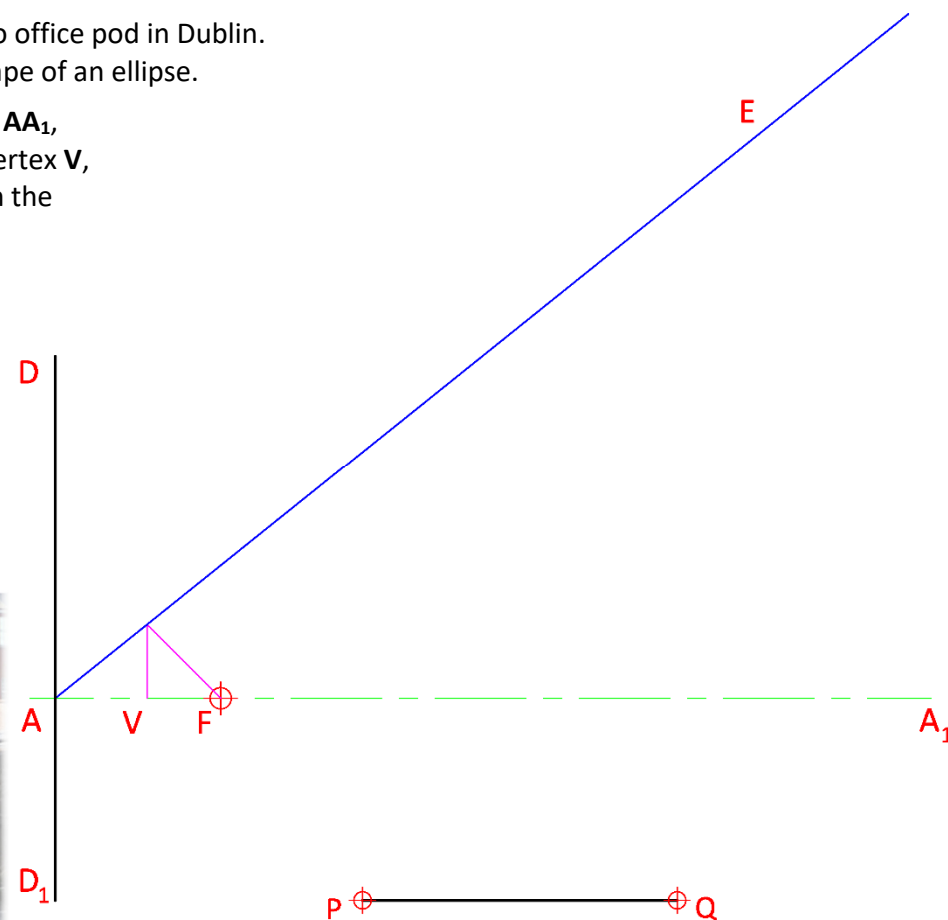

A-4. The graphic below shows a salt shaker. The shaker consists of a pentagonal-based pyramid and square-based prism which intersect each other.

The drawing on the right shows the plan and incomplete elevation of the shaker.

- (a) Complete the elevation, showing all lines of interpenetration.
- (b) Determine the true shape of surface **S**.

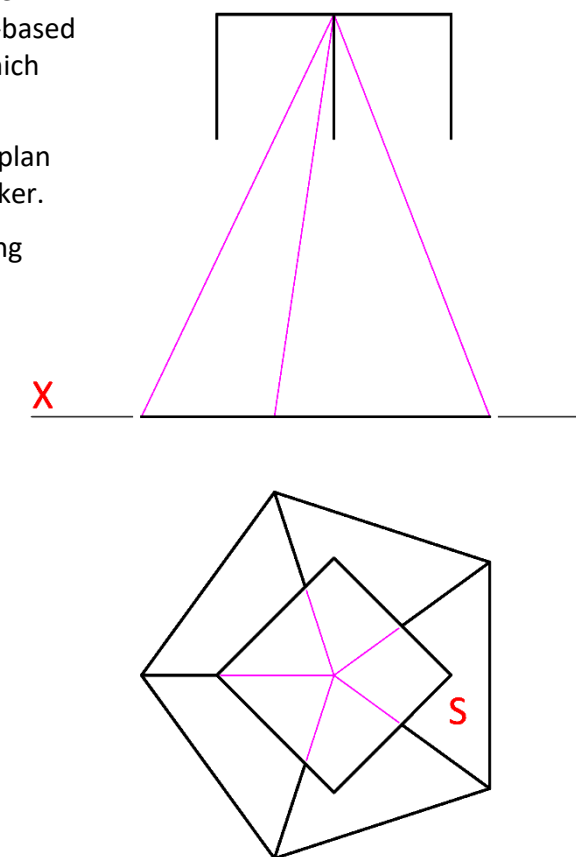
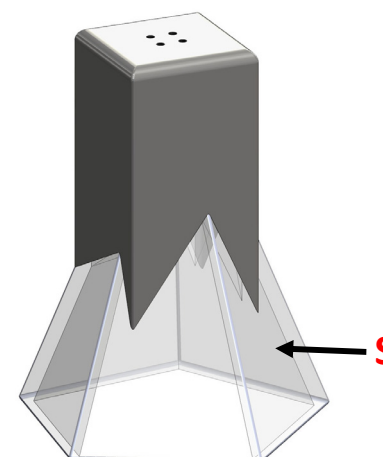

This Contour Map is part of Section C and should only be used for the answering of the Geologic Geometry Option (Question C-1).
(Scale 1:1,000)

